

1. THERMOCOUPLES AND BAYONET ADAPTER

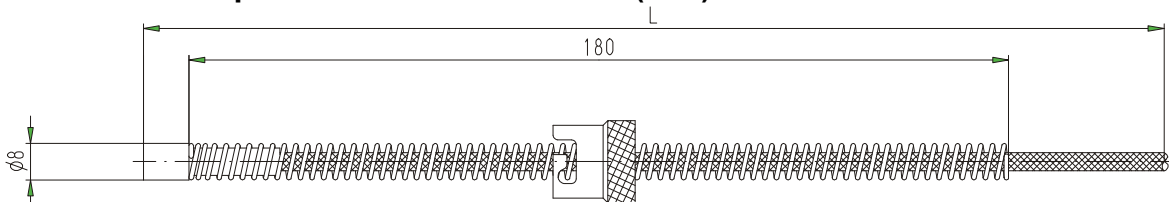

Use only from UNITEK recommended thermocouples!
Please infer the type of thermocouple bores from the parts list:
 for casing TF0: use thermocouples with flat contact area (0°).
 for casing TF120: use thermocouples with 120°-contact area.

1.1. Thermocouples with flat contact area (TF0)



art. no. 1.9005.0001		art. no. 1.9005.0002	
7012.1.FK-L.i.8.P.18.VK-17.5000.A.400°C		7012.1.NC.i.8.P.18.VK-17.5000.A.400°C	
7012	type	7012	type
1	number of thermocouples	1	number of thermocouples
FK	material Fe-CuNi (type J)	NC	material NiCr-Ni (type K)
i	isolated	i	isolated
8	diameter	8	diameter
P	contact area flat	P	contact area flat
18	spring 180mm	18	spring 180mm
VK-17	bayonet fitting	VK-17	bayonet fitting
5000	length of conductor	5000	length of conductor
A	solder end	A	solder end
400°C	max. temperature	400°C	max. temperature

1.2. Thermocouples with contact area 120° (TF120)

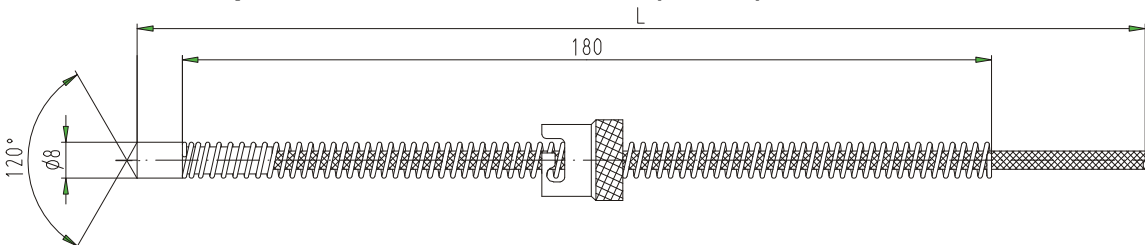

art. no. 1.9005.0046		art. no. 1.9005.0047	
7012.1.FK-L.i.8.W.18.VK-17.5000.A.400°C		7012.1.NC.i.8.W.18.VK-17.5000.A.400°C	
7012	type	7012	type
1	number of thermocouples	1	number of thermocouples
FK	material Fe-CuNi (type J)	NC	material NiCr-Ni (type K)
i	isolated	i	isolated
8	diameter	8	diameter
W	contact area 120°	W	contact area 120°
18	spring 180mm	18	spring 180mm
VK-17	bayonet fitting	VK-17	bayonet fitting
5000	length of conductor	5000	length of conductor
A	solder end	A	solder end
400°C	max. temperature	400°C	max. temperature

1.3. Bayonet adapter GN-44-40-R85

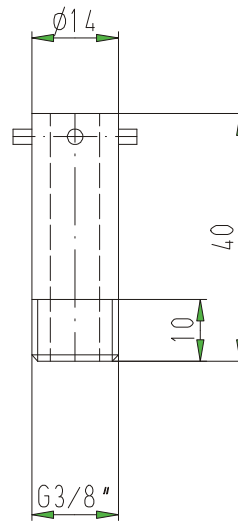

Properly working thermocouples are essential for a correct temperature setting and control. Check the state of the thermocouples on a regular base:

- Make sure the thermocouple bores are clean and rust-free.
- Make sure that the tip of the thermocouple has a good contact – air gaps, rust or dirt can lead to misreadings.
- Make sure that the type settings (J, K) in the line control are identical with your used thermocouple.
- Do not use different thermocouple types in the same line control.
- Respect the polarity of the thermocouple connector.
- Never connect more than one thermocouple to the same electric terminal.
- Make sure the thermocouple is properly connected to the bayonet adapter and that the spring is pretensioned.
- Make sure that the control wire is not twisted or sharply bended.



If you are not sure whether the thermocouple is working properly, cross-check it with an IR-thermometer.